

CADERNO DE MARCENARIA

ESCOLA MUNICIPAL DE EDUCAÇÃO INFANTIL PRIMEIROS PASSOS
Rua Gustavo Emilio Xavier, 640, Bairro Costa Doce - Arambaré / RS

Novembro, 2023

COZINHA.....	1
ESTANTE COM NICHOS COLORIDOS.....	12
PRATELEIRAS PARA BRINQUEDOS.....	16
ARMÁRIO com espaço embutido para café.....	17
BALCÃO GAVETEIRO.....	19
ARMÁRIOS para armazenamento de papéis.....	20
BALCÃO REFEITÓRIO.....	22

COZINHA

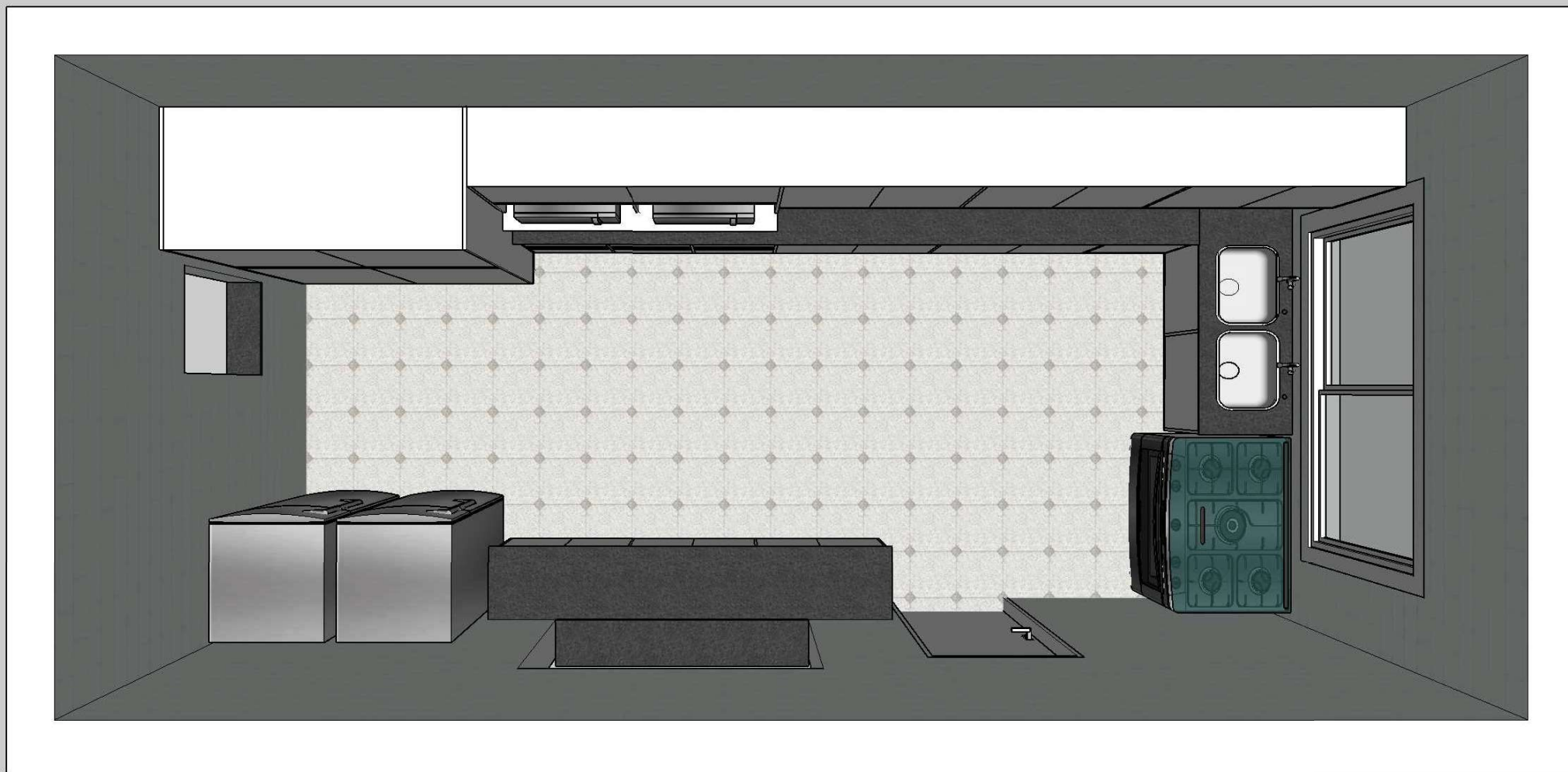

PLANTA BAIXA

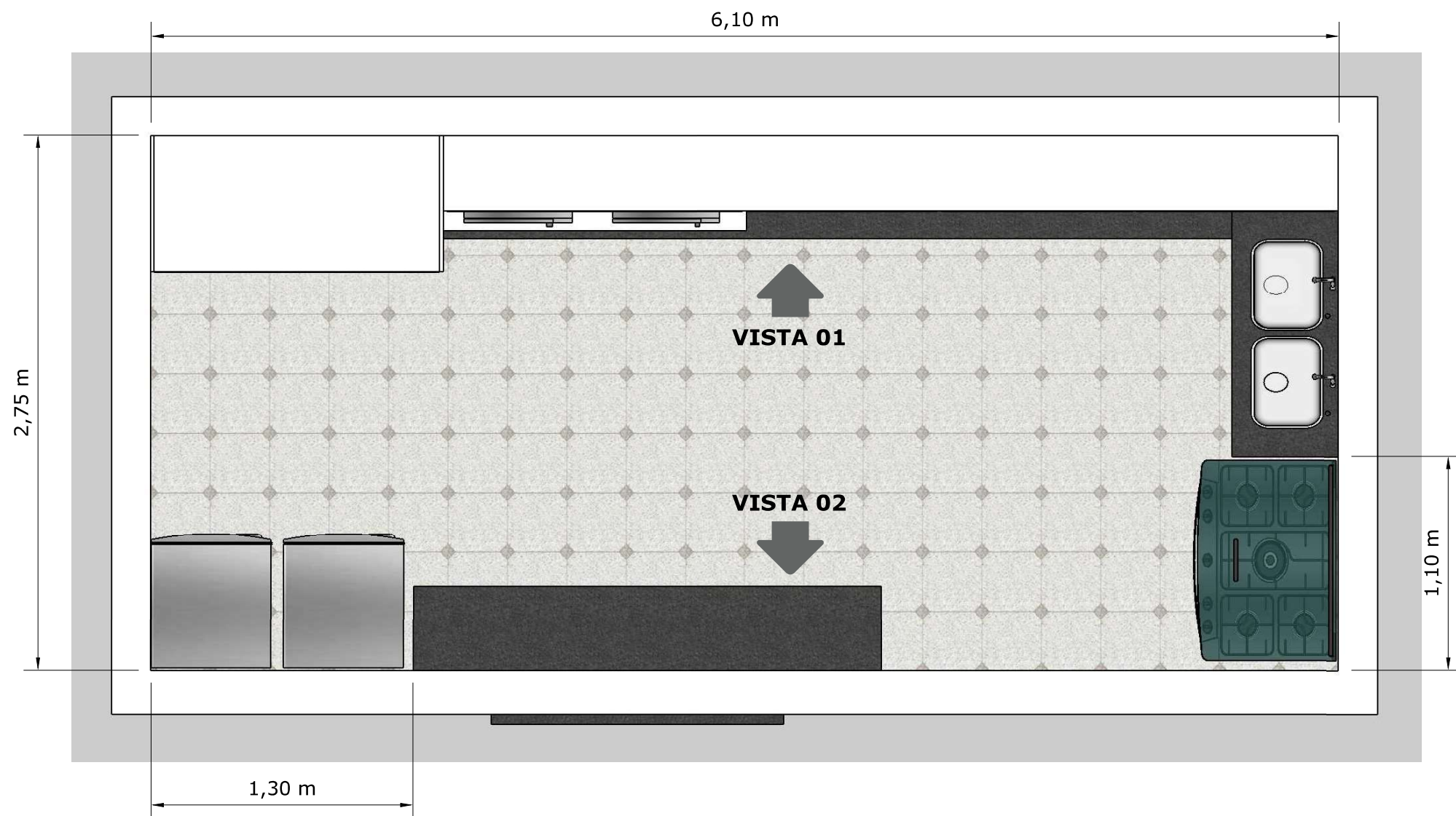

VISTA 01

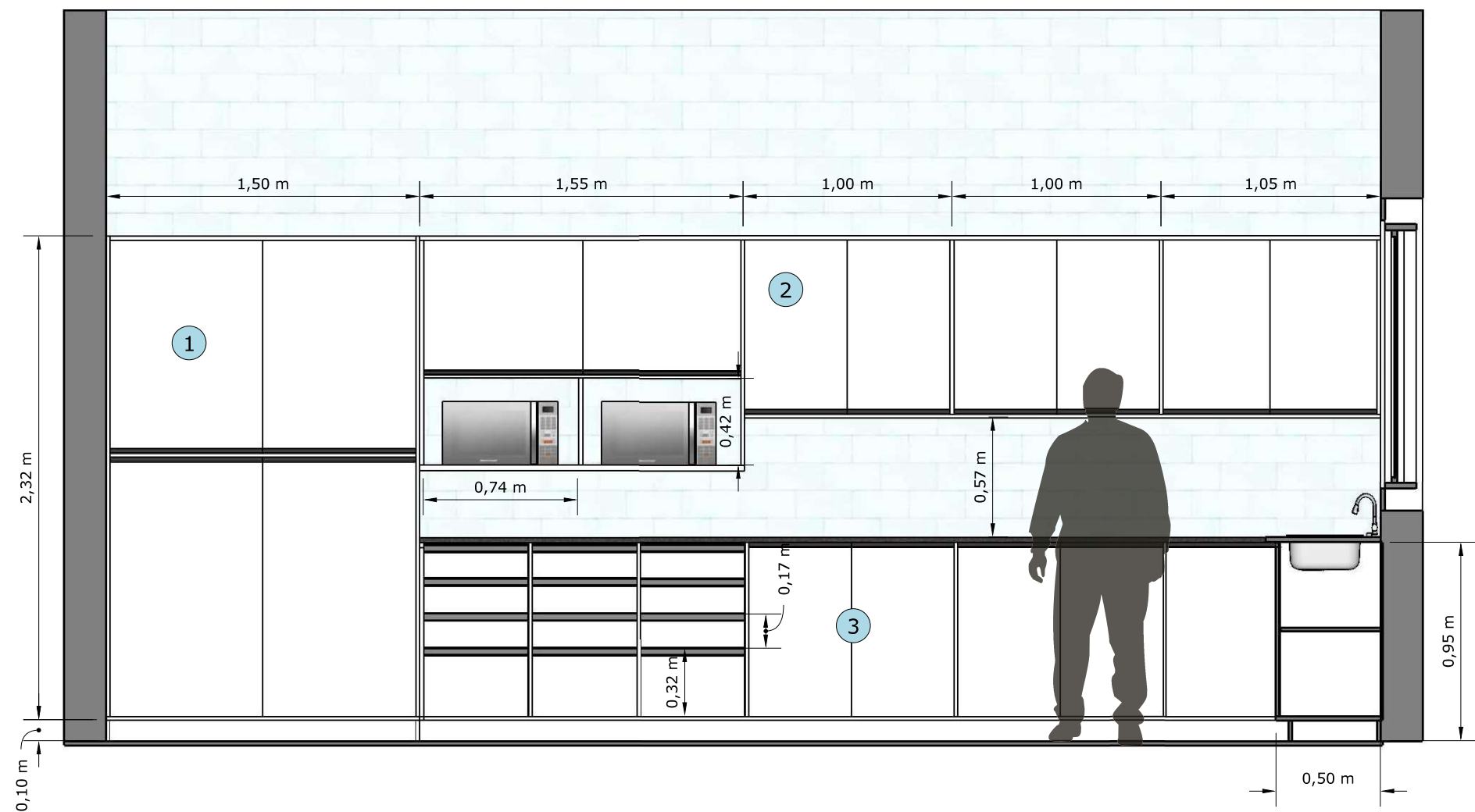

1 PANELEIRO

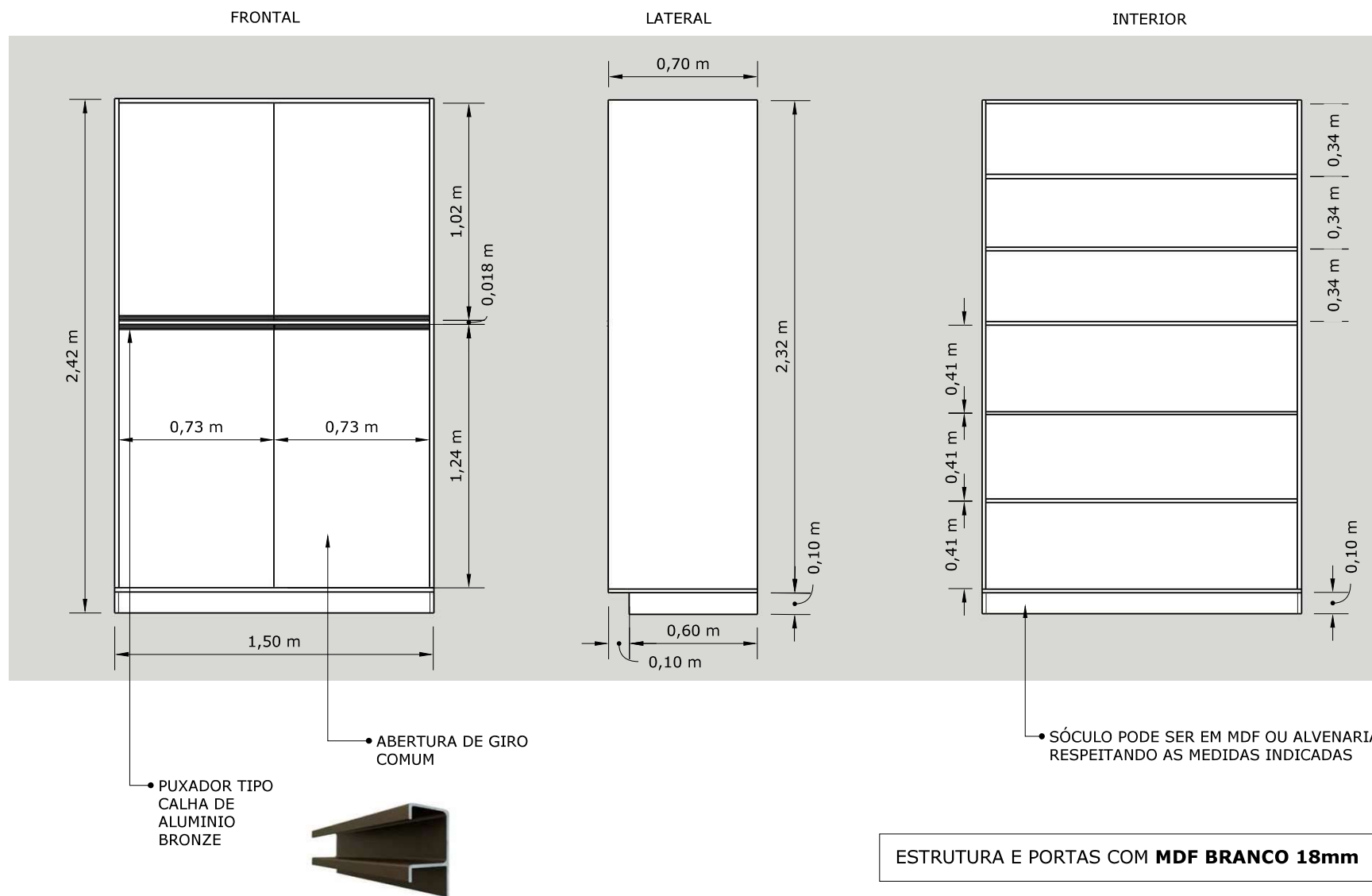

escala 1:20mm

2 ARMÁRIO AÉREO

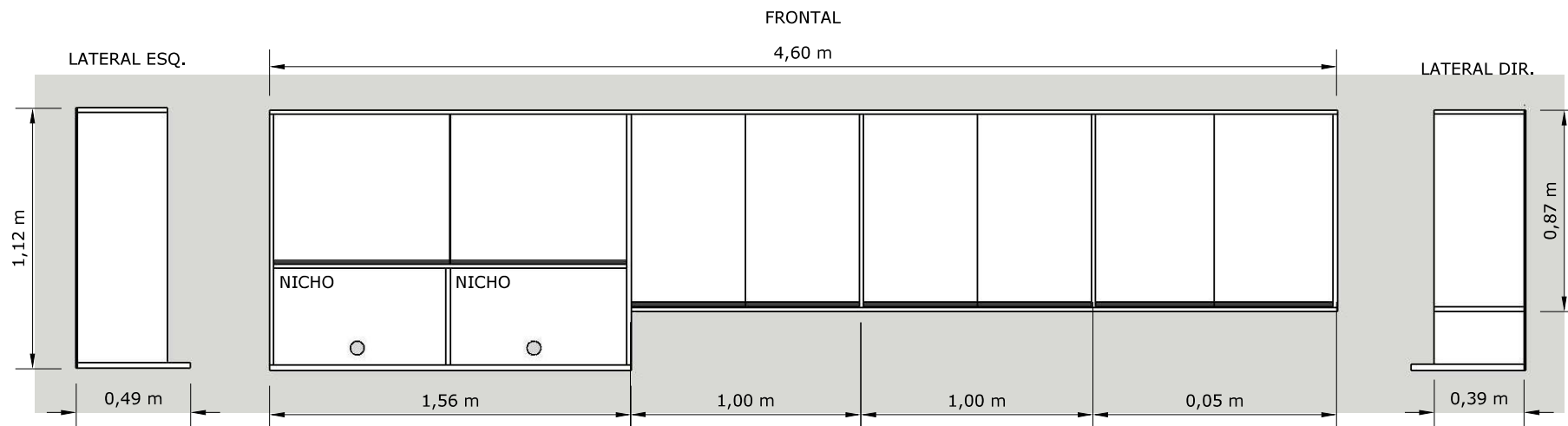

ESTRUTURA E PORTAS COM
MDF BRANCO 18mm

BASE DOS NICHOS
MDF BRANCO 25mm

FECHAMENTO DO FUNDO
MDF BRANCO 6mm

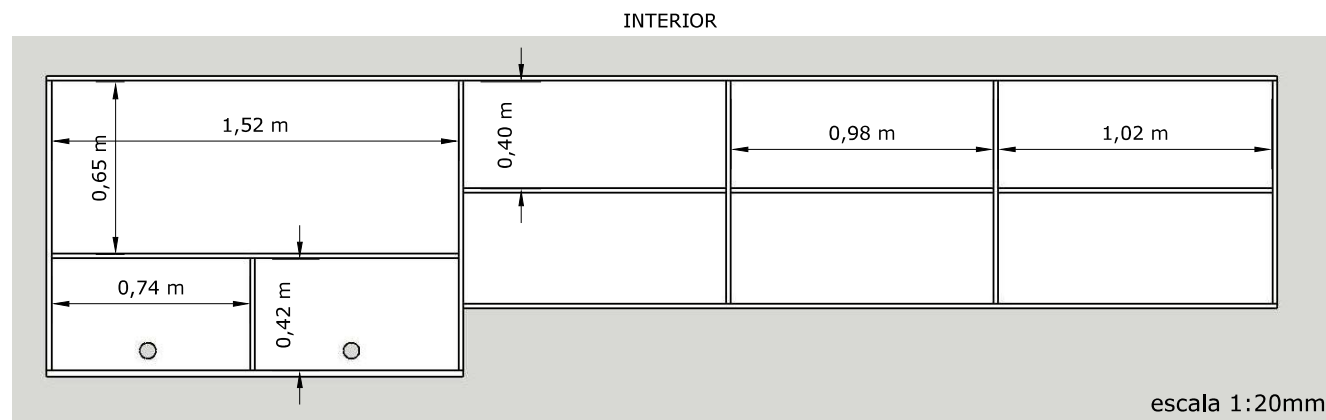

ABERTURAS DE GIRO COMUM

PUXADOR TIPO
CALHA DE
ALUMINIO
BRONZE

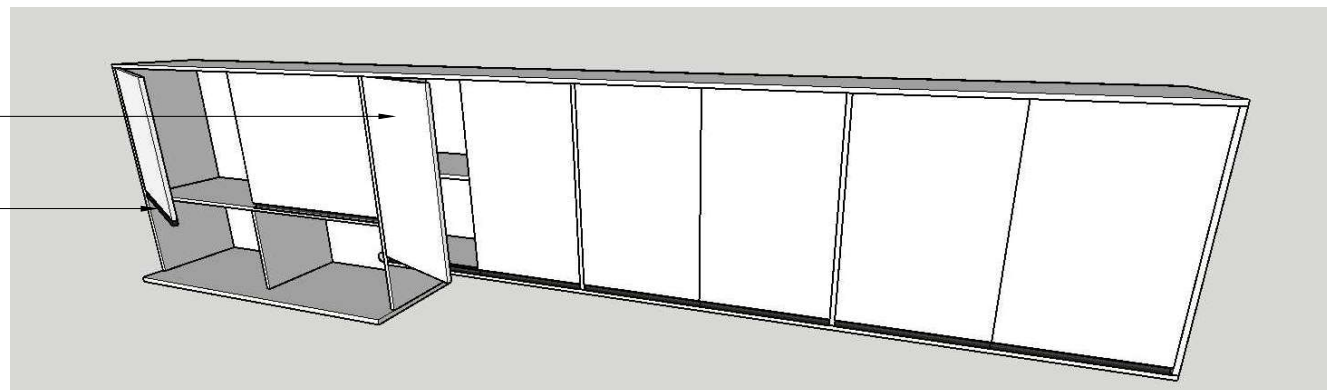

2 BANCADA

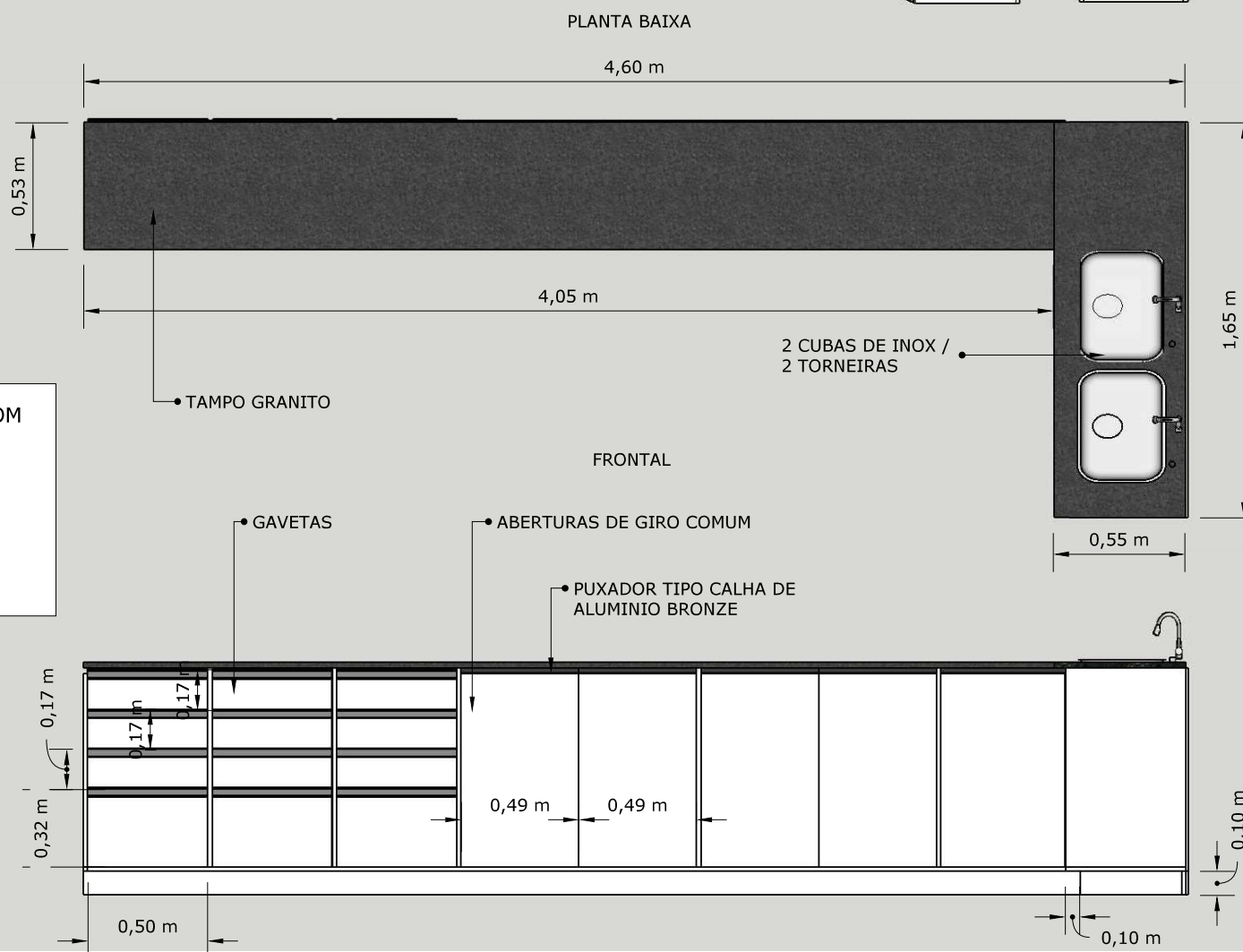
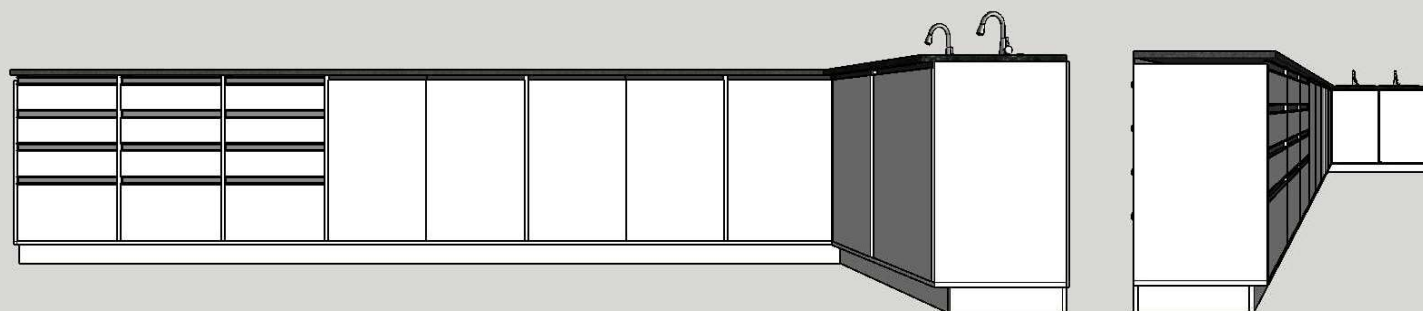

ESTRUTURA E PORTAS COM
MDF BRANCO 18mm

CAIXA GAVETA
MDF BRANCO 15mm

FECHAMENTO DO FUNDO
MDF BRANCO 6mm

escala 1:20mm

2 BANCADA

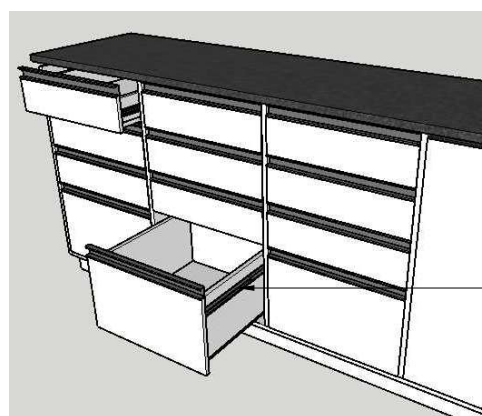
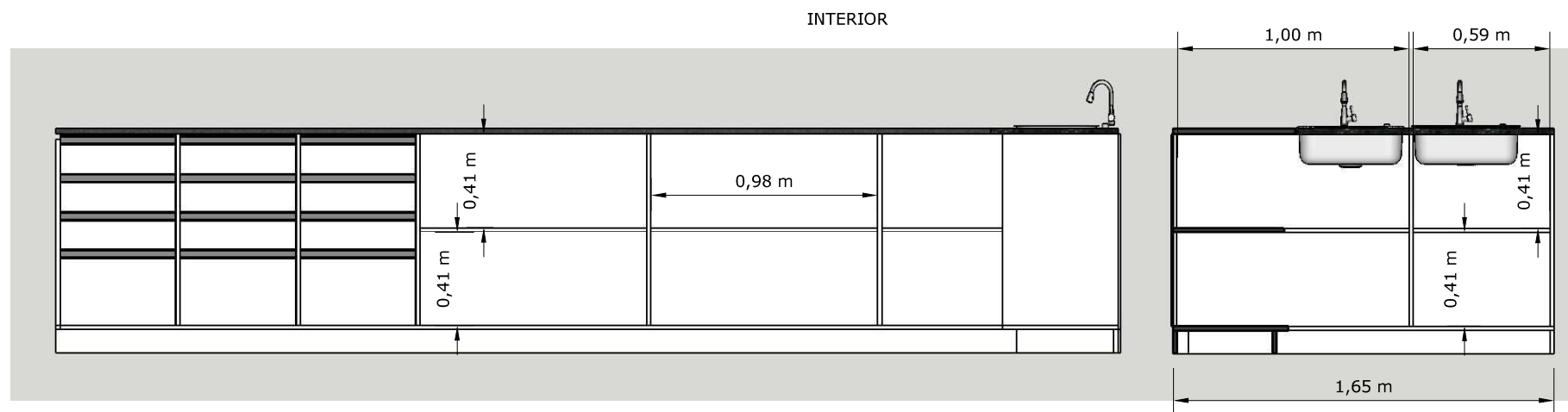

PORTAS DO CANTO
Dobradiças 165°

- Corrediça telescópica de metal 45cm
Suporta até 20kg e permite a abertura total da gaveta

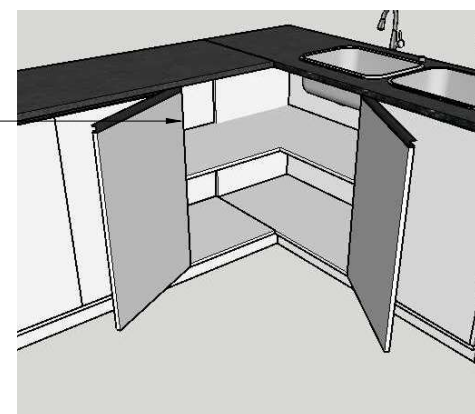

VISTA 02

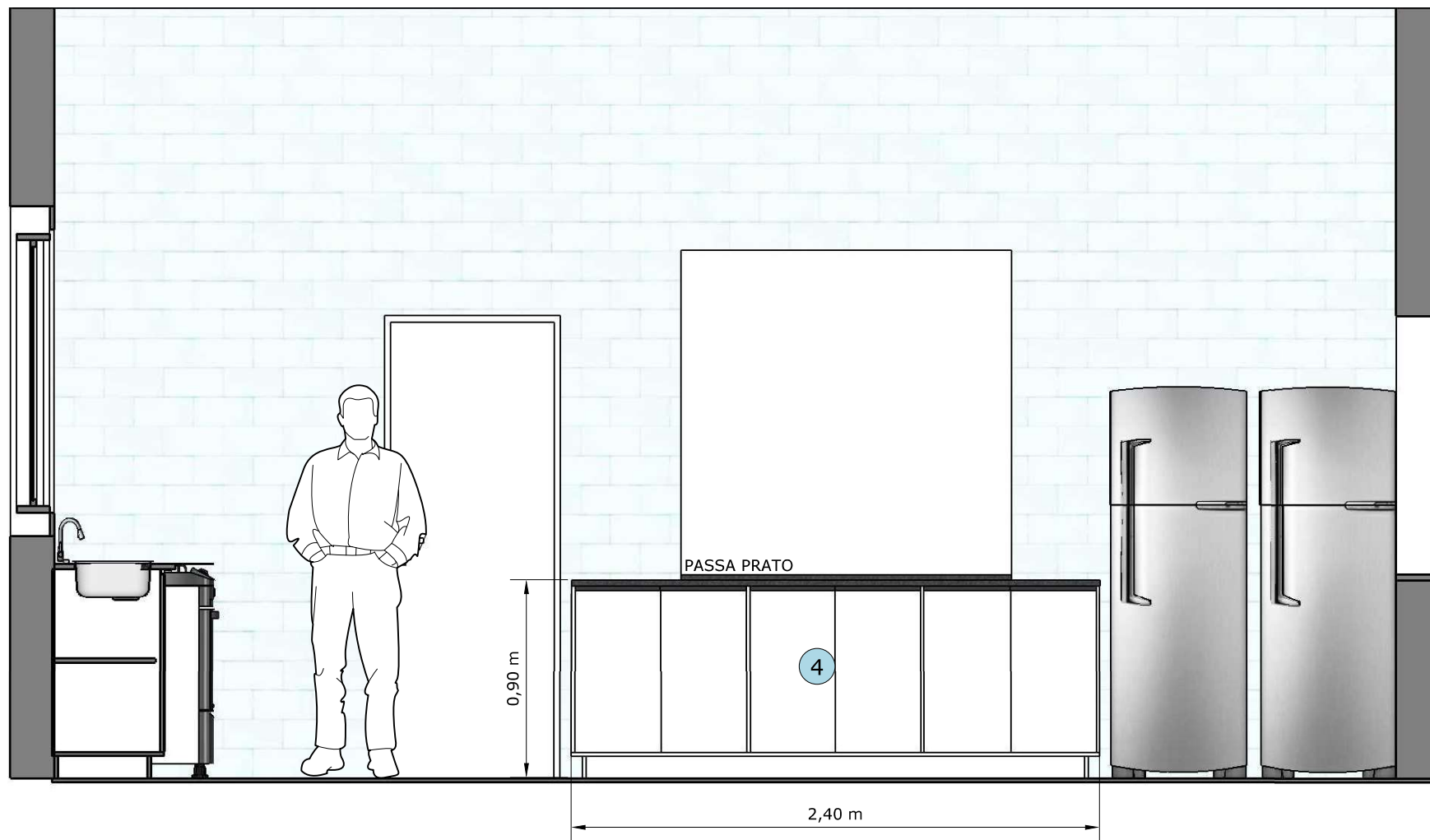

BALCÃO DE APOIO PASSA PRATO

